

NEFTIM

SIGNAL TOWER LIGHT

INDUSTRIAL LIGHTING



LAMP-L series



Application:

Automated assembly line, Automation equipment, Security inspection equipment, LED packaging equipment, Alarming system, SMT equipment, CNC machine, Engraving machine, Milling machine, etc.

Features:

1. Built-in buzzer, sound >85dB
2. Imported multi - color led chips, high bright, stable and long lifespan
3. Modular design, 180 degree adjustable

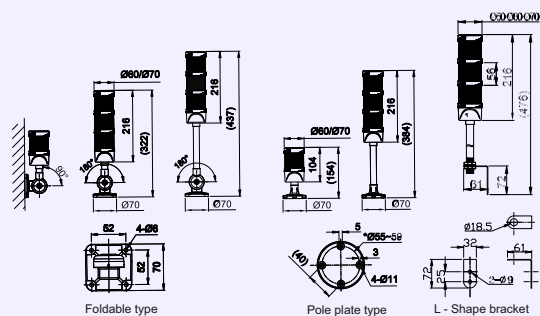

TECHNICAL PARAMETERS AND DRAWING

Current	Single color : <50mA	Buzzer : 18mA
Flash frequency	63-65 times/min	
Buzzer volume	> 85dB	
IP rating	With buzzer IP53 / Without buzzer IP65	
Working temperature	-20~45℃	
Lifetime	50,000H	
Housing color	Black, Gray, White	
Installation	Fixed by screw	
Material	Body: ABC , Lens: PC , Base: PA+15%GF	



LAMP-L 3 A B B T RYG 60
1 2 3 4 5 6 7 8

1	Model No	LAMP-L
2	Layer	1, one layer 2, two layers 3, three layers 4, four layers 5, five layers
3	Mounting	A, Foldable type C, Pole plate type E, L-shape bracket
4	Voltage	A, AC/DC12V B, DC24V C, AC100-265V 50/60Hz
5	Function	B, Steady F, Steady with buzzer S, Red flash C, Red flash with buzzer D, All flash E, All flash with buzzer
6	Connect type	T, PNP&NPN C, Contact type
7	Color	R, Red Y, Yellow G, Green B, Blue W, White
8	Diameter	50, φ 50mm 60, φ 60mm 70, φ 70mm

LAMP-B series



Application:

Automated assembly line, Automation equipment, Security inspection equipment, LED packaging equipment, Alarming system, SMT equipment, CNC machine, Engraving machine, Milling machine, etc.

Features:

1. 3 colors in 1 layer, DC24V, buzzer optional (optional)
2. Anodized black aluminum + Milky cover
3. NPN & PNP output options
4. Connection short cable or M12 , 4 pins connector

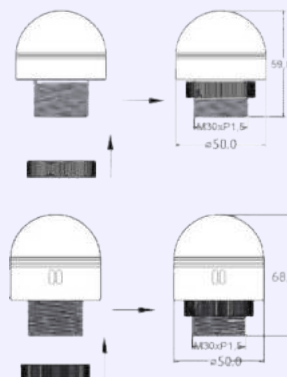

TECHNICAL PARAMETERS AND DRAWING

Current	Single color : <50mA	Buzzer : 18mA
Flash frequency	63-65 times/min	
Buzzer volume	< 85dB	
IP rating	With buzzer IP53 / Without buzzer IP65	
Working temperature	- 20 ~ 45 °C	
Lifetime	50,000H	
Housing color	Black	
Installation	Fixed by thread	
Material	Body: Aluminum , Cover: PC	



LAMP-B - **1** **B** **B** **T** **RYG** **50**

1 **2** **3** **4** **5** **6** **7**

1	Model No.	LAMP-B
2	Layer	1 Layer
3	Voltage	B. DC24V
4	Function	B. Steady F. Steady with buzzer S. Red flash C. Red flash with buzzer D. All flash E. All flash with buzzer
5	Connect type	T. PNP&NPN C. Contact type
6	Color	R. Red Y. Yellow G. Green
7	Diameter	50. Ø 50mm

LAMP-ST series



Application:

Automated assembly line, Automation equipment, Security equipment, LED encapsulation equipment, Alarm system, SMT equipment, CNC machine tool, Engraving machine, Lathe, Milling machine, Mining machinery.

Feature:

1. Easy mounting, foldable base, convenient for transportation.
2. Use transparent PC cover, yellowing-proof.
3. Buzzer inside, sound $\geq 85\text{dB}$.

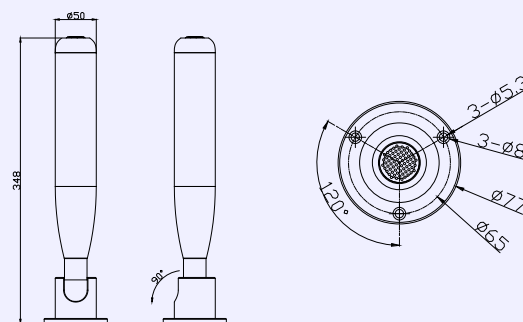

TECHNICAL PARAMETERS AND DRAWING

Current	Red: 50mA Green: 35mA	Yellow: 90mA Buzzer: 12mA
Flash frequency	63–65 times	
Buzzer volume	$>85\text{dB}$	
IP rating	IP50	
Working temperature	$-20\sim 45^{\circ}\text{C}$	
Lifetime	50,000H	
Housing color	Silver	
Installation	Fixed by screw	
Material	PC cover + Aluminum body	



LAMP-ST

	A	3	B	B	B
1	2	3	4	5	6
1 Model No.	LAMP-ST				
2 Shape	A. Baseball type				
3 Layer	3 Layers				
4 Voltage	B. DC24V				
5 Connect type	C. Contact type Z. NPN B. PNP				
6 Function	B. Steady				
	F. Steady with buzzer				
	S. Red flash				
	C. Red flash with buzzer				
	D. All flash				
	E. All flash with buzzer				

LAMP-SC series



Application:

Automated assembly line, Automation equipment, Security equipment, LED encapsulation equipment, Alarm system, SMT equipment, CNC machine tool, Engraving machine, Lathe, Milling machine, Mining machinery.

Feature:

1. Easy mounting, foldable base hidden in lamp body, convenient for transportation.
2. Use transparent PC cover, yellowing-proof.
3. Buzzer inside, sound $\geq 85\text{dB}$.

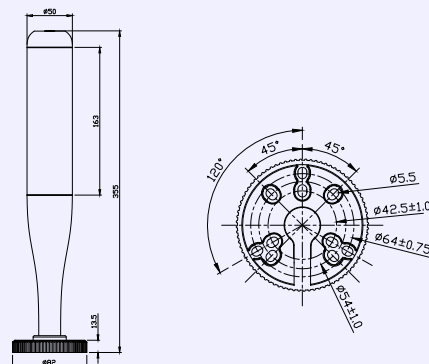

TECHNICAL PARAMETERS AND DRAWING

Current	Red: 50mA	Yellow: 90mA
	Green: 35mA	Buzzer: 12mA
Flash frequency	63–65 times	
Buzzer volume	$>85\text{dB}$	
IP rating	IP50	
Working temperature	$-20\sim 45^{\circ}\text{C}$	
Lifetime	50,000H	
Housing color	Silver	
Installation	Fixed by screw	
Material	PC cover + Aluminum body	



LAMP-SC



1	Model No.	LAMP-SC			
2	Shape	A. Baseball type			
3	Layer	3 Layers			
4	Voltage	B. DC24V			
5	Connect type	C. Contact type Z. NPN B. PNP			
6	Function	B. Steady			
		F. Steady with buzzer			
		S. Red flash			
		C. Red flash with buzzer			
		D. All flash			
		E. All flash with buzzer			

LAMP-T series



Application:

Automated assembly line, Automation equipment, Security inspection equipment, LED packaging equipment, Alarming system, SMT equipment, CNC machine, Engraving machine, Milling machine, etc.

Feature:

1. Provide logo customized service.
2. Built-in buzzer, sound > 85dB.
3. Imported multi color led chips, high bright, high quality and long lifespan.
4. Double lampshade, tri-color in single layer, delicate and practical.

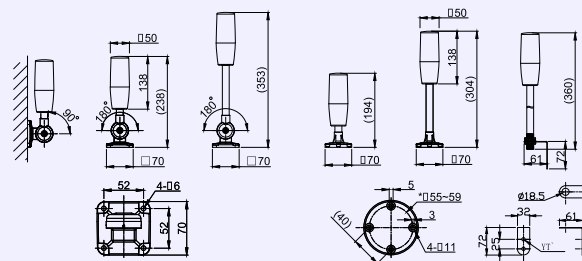

Foldable type

Pole plate type

L-Shape bracket

TECHNICAL PARAMETERS AND DRAWING

Current	Red: 29mA Green: 32mA	Yellow: 28mA Buzzer: 18mA
Flash frequency	63-65 times/min	
Buzzer volume	> 85 db	
IP rating	IP 53	
Working temperature	- 20 ~ 45 °C	
Lifetime	50,000H	
Housing color	Silver	
Installation	Fixed by screw	
Material	Body: ABS , Lens: PC , Base: PA + 15% GF	



LAMP-T 1 A B B T RYG 50

1	Model No.	LAMP-T
2	Layer	1 Layer
3	Mounting	A. Foldable type C. Pole plate type E. L-shaped bracket
4	Voltage	A. AC/DC12V B. DC24V C. AC100 - 265V 50/60Hz
5	Function	B. Steady F. Steady with buzzer S. Red flash C. Red flash with buzzer D. All flash E. All flash with buzzer
6	Connect type	T. PNP&NPN C. Contact type
7	Color	R. Red Y. Yellow G. Green
8	Diameter	Ø 50mm

LAMP-C series



Application:

Automated assembly line, automation equipment, security equipment, LED packaging equipment, alarm systems, SMT equipment, CNC lathe, CNC machine, engraving machine, CNC milling machines, mining equipment.

Feature:

1. Disc installation, seamless with the equipment, can be folded down during transportation
2. Built-in buzzer, sound > 85dB.
3. Imported multi color led chips, high bright, high quality and long lifespan.
4. Double lampshade, tri-color in single layer, light is soft and bright.

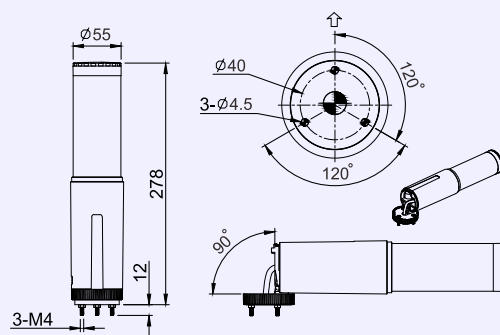

TECHNICAL PARAMETERS AND DRAWING

Current	Red: 58mA	Yellow: 56mA
	Green: 41mA	Buzzer: 19mA
Flash frequency	63-65 times/min	
Buzzer volume	> 85 db	
IP rating	IP 53	
Working temperature	- 20 ~ 45 °C	
Lifetime	50,000H	
Housing color	Silver	
Installation	Fixed by screw	
Material	Body: ABS, Lens: PC, Base: P + 15% GF	



LAMP-C 1 A B B T RYG 60
1 2 3 4 5 6 7 8

1	Model No.	LAMP-C
2	Layer	1 Layer
3	Mounting	A. Foldable type
4	Voltage	A. AC/DC12V B. DC24V C. AC100 - 265V 50/60Hz
5	Function	B. Steady F. Steady with buzzer S. Red flash C. Red flash with buzzer D. All flash E. All flash with buzzer
6	Connect type	T. PNP&NPN C. Contact type
7	Color	R. Red Y. Yellow G. Green
8	Diameter	Ø 60mm

LAMP-W series

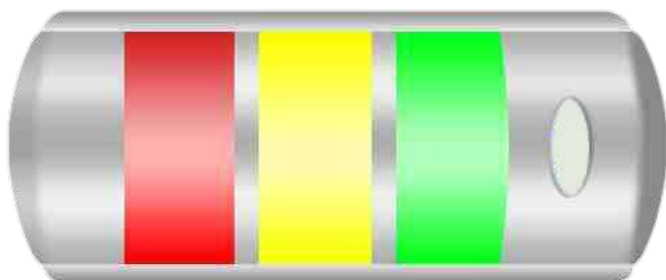

Application:

Automated assembly line, automation equipment, security equipment, LED packaging equipment, alarm systems, SMT equipment, CNC lathe CNC machine, engraving machine, CNC milling machines, mining equipment.

Feature:

1. ABS body with chrome plating, elegant appearance.
2. Double PC lens make light soft.
3. Logo print service available.
4. Easy to install, hanging and screw mounting available.

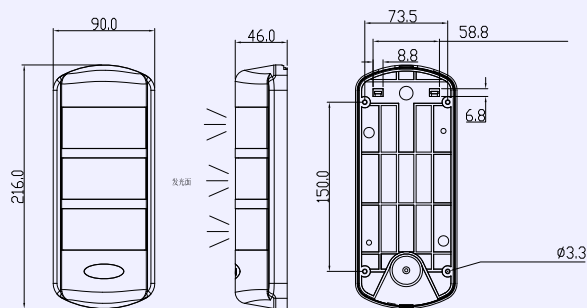

TECHNICAL PARAMETERS AND DRAWING

Current	Single color: <50mA Buzzer: 19mA
Flash frequency	63-65 times/min
Buzzer volume	> 90 db
IP rating	IP 65
Working temperature	- 20 ~ 45 °C
Lifetime	50,000H
Housing color	Silver
Installation	Fixed by screw
Material	Body: ABS, Lens: PC



LAMP-W-B-B-T-RYG

1	2	3	4	5
1 Model No.	LAMP-W			
2 Voltage	B. DC24V			
3 Function	B. Steady F. Steady with buzzer S. Red flash C. Red flash with buzzer D. All flash E. All flash with buzzer			
4 Connect type	T. PNP&NPN C. Contact type			
5 Color	R. Red Y. Yellow G. Green			

LAMP-H / HS series



LAMP-H



LAMP-HS



Application:

Automated assembly line, automation equipment, security equipment, LED packaging equipment, alarm systems, SMT equipment, CNC lathe, CNC machine, engraving machine, CNC milling machines, mining equipment.

Feature:

1. Whole aluminum alloy profile.
2. Corn lampshade to make the light more uniform and bright.
3. Tri-color in single layer, industry trends, with buzzer inside.

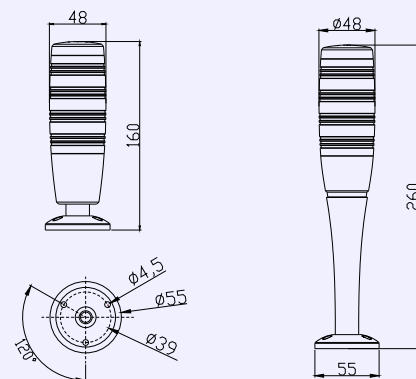

TECHNICAL PARAMETERS AND DRAWING

Current	Red: 49mA	Yellow: 48mA
Flash frequency	Green: 41mA	Buzzer: 22mA
Buzzer volume	63-65 times/min	
Buzzer volume	> 95 db	
IP rating	IP 53	
Working temperature	- 20 ~ 45 °C	
Lifetime	50,000H	
Housing color	Silver	
Installation	Fixed by screw	
Material	Body: ABS, Lens: PC, Base: P + 15% GF	



LAMP-H / LAMP-HS — 1 A B B T RYG 48

1	Model No.	LAMP-H / LAMP-HS
2	Layer	1. Layer
3	Mounting	A. Pole plate type
4	Voltage	B. DC24V
5	Function	B. Steady F. Steady with buzzer S. Red flash C. Red flash with buzzer D. All flash E. All flash with buzzer
6	Connect type	T. PNP&NPN C. Contact type
7	Color	R. Red Y. Yellow G. Green
8	Diameter	48. Ø 48mm

LAMP-P series



Application:

Security equipment, LED packaging equipment, alarm systems, SMT equipment, CNC lathes, CNC machine, engraving machine, CNC milling machines.

Features:

1. Super bright LED source. Tricolor in single layer. Enhance recognition effect.
2. Can be folded down during transportation. Sound of buzzer can reach to 95 dB.

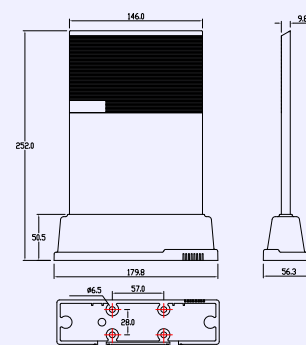

TECHNICAL PARAMETERS AND DRAWING

Current	Red: 31mA Green: 45mA	Yellow: 42mA Buzzer: 15mA
Flash frequency	63-65 times/min	
Buzzer volume	> 95 db	
IP rating	IP 43	
Working temperature	- 20 ~ 45 °C	
Lifetime	50,000H	
Housing color	Silver	
Installation	Fixed by screw	
Material	ABS base + Synthetic quartz body	



LAMP-P 1 A B B T RYG

1	Model No.	LAMP-P
2	Layer	1 Layer
3	Mounting	A. Foldable type
4	Voltage	B. DC24V
5	Function	B. Steady F Steady with buzzer S. Red flash C. Red flash with buzzer D. All flash E. All flash with buzzer
6	Connect type	T. PNP&NPN C. Contact type
7	Color	R. Red Y. Yellow G. Green

LAMP-G series



Application:

Security equipment, LED packaging equipment, alarm systems, SMT equipment, CNC lathes, CNC machine, engraving machine, CNC milling machines.

Feature:

1. Triangular prism design, fashion appearance.
2. ABS lamp body with shining coating, elegant.
3. Aluminum base, durable.

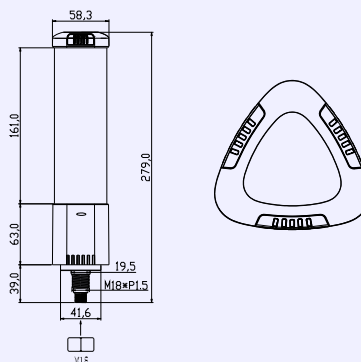

TECHNICAL PARAMETERS AND DRAWING

Current	Single color: < 50mA	Buzzer: 15mA
Flash frequency	63-65 times/min	
Buzzer volume	> 90 db	
IP rating	IP 43	
Working temperature	- 20 ~ 45 °C	
Lifetime	50,000H	
Housing color	Silver	
Installation	Fixed by screw	
Material	Body: ABS , Lens: PC , Base: P + 15% GF	



LAMP-G A B B T RYG

1	Model No.	LAMP-G
2	Mounting	A. Foldable type
3	Voltage	A. AC/DC12V B. DC24V C. AC100 - 265V 50/60Hz
4	Function	B. Steady F. Steady with buzzer S. Red flash C. Red flash with buzzer D. All flash E. All flash with buzzer
5	Connect type	T. PNP&NPN C. Contact type
6	Color	R. Red Y. Yellow G. Green

LAMP-Y series



Application:

Security equipment, LED packaging equipment, alarm systems, SMT equipment, CNC lathes, CNC machine, engraving machine, CNC milling machines.

Feature :

1. Provide Logo customize service, Can highlight customer's brand.
2. Super bright Led source, Tricolor in single layer, Enhance the recognition effect.
3. Can be folded down during transportation. Sound of buzzer can reach to 90dB.
4. Easy to install, multiple mounting holes to fit different equipments.



TECHNICAL PARAMETERS AND DRAWING

Current	Red: 35mA Green: 45mA	Yellow: 41mA Buzzer: 19mA
Flash frequency	63-65 times/min	
Buzzer volume	> 90 db	
IP rating	IP 43	
Working temperature	- 20 ~ 45 °C	
Lifetime	50,000H	
Housing color	Silver	
Installation	Fixed by screw	
Material	Body: PMMA, Base: AL	



LAMP-Y — **B** **B** **T** **RYG**



1	Model No.	LAMP-Y
2	Voltage	B. DC24V
3	Function	B. Steady F. Steady with buzzer S. Red flash C. Red flash with buzzer D. All flash E. All flash with buzzer
4	Connect type	T. PNP&NPN C. Contact type
5	Color	R. Red Y. Yellow G. Green

LAMP-M series



Application:

Large machine equipment contour decoration, Automated workstation status indicator field.

Feature:

- 1, Tricolor rigid strip, decoration, improve the level of machine.
- 2, Design on or beside the door of machine, synchronized with the tri-color warning lamp. It is more convenient for the operator to understand the machine running state when operator to understand the machine running state when operator is close to machine
- 3, Adopted by DMG, Hardinge, lead the trend.

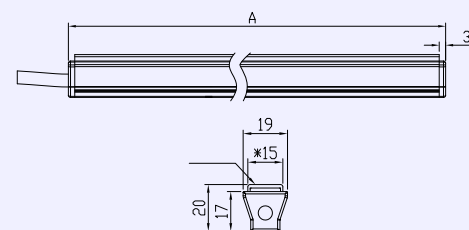

Width of emitting area

Length of light (A)	130	238	346	454	670	778	994	1102	1210	1426	1534	1750	2074
Length of light cover (B)	126	234	342	450	666	774	990	1098	1206	1422	1530	1746	2070
	15												
Width of body area	16												

TECHNICAL PARAMETERS AND DRAWING

Power	Red: 3.7 w/m Yellow: 3.3 w/m Green: 3.7 w/m
Cable length	15 cm
Luminous color	Tri colors: RYG Single color: R, Y, G, W
IP rating	IP 40
Working temperature	- 20 ~ 45 °C
Lifetime	40,000H
Housing color	Cream white
Installation	Clips / Recess
Material	Lens: PC

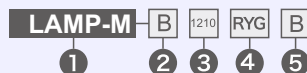

① Model No.	LAMP-M
② Voltage	B. DC24V
③ Length	130mm ... 788mm 1210mm 1534mm 1700mm ... 2074mm
④ Color	R. Red Y. Yellow G. Green
⑤ Connect type	Z. NPN B. PNP

LAMP-30 series



Application:

Automated assembly line, automation equipment, security equipment, LED packaging equipment, alarm systems, SMT equipment, CNC lathe CNC machine, engraving machine, CNC milling machines, mining equipment.

Feature:

1. Exquisite structure, simple and beautiful, cost-effective.
2. Imported light source, domestic famous brand power supply to ensure that the product lifespan is more than three years.
3. 30mm Diameter, delicate and practical.
4. Double lampshade, soft and bright light, buzzer optional.

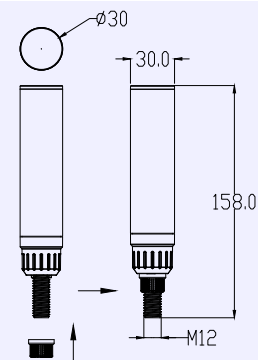

TECHNICAL PARAMETERS AND DRAWING

Current	Red: 30mA	Yellow: 30mA
	Green: 30mA	Buzzer: 20mA
Flash frequency	63-65 times/min	
Buzzer volume	> 85 db	
IP rating	IP 43	
Working temperature	- 20 ~ 45 °C	
Lifetime	50,000H	
Housing color	White	
Installation	Pole plate type	
Material	Body: ABS Lens: PC	



LAMP-30 3 A B B T RYG 30

1 2 3 4 5 6 7 8

1	Model No.	LAMP-30
2	Layer	3. Layers
3	Mounting	A. Pole plate type
4	Voltage	A: DC12V B. DC24V
5	Function	B. Steady F. Steady with buzzer S. Red flash C. Red flash with buzzer D. All flash E. All flash with buzzer
6	Connect type	T. PNP & NPN
7	Color	R. Red Y. Yellow G. Green
8	Diameter	30. Ø 30mm

LAMP series wiring instruction

LAMP-L

Connect type: PNP

Connect type: NPN

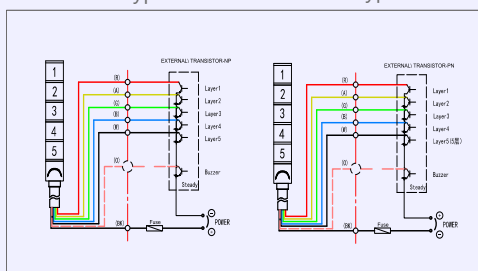

Connect type: Contact type

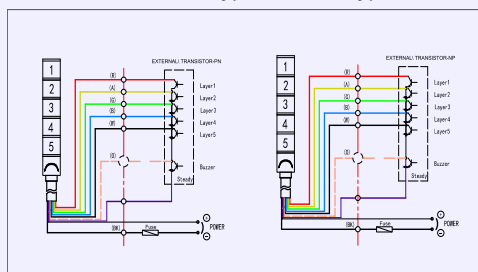

LAMP-S

Connect type: PNP

Connect type: NPN

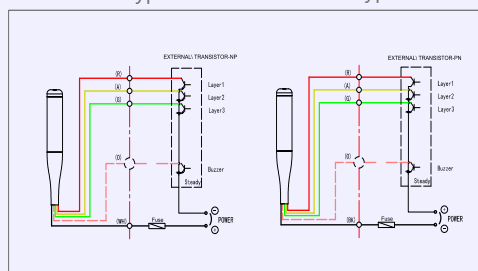

Connect type: Contact type

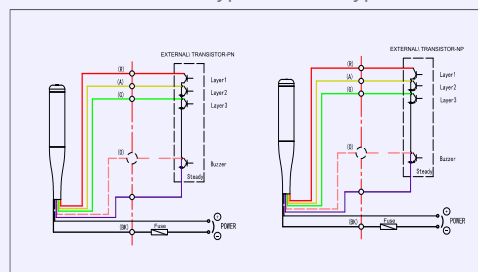

LAMP-T / LAMP-C

Connect type: PNP

Connect type: NPN

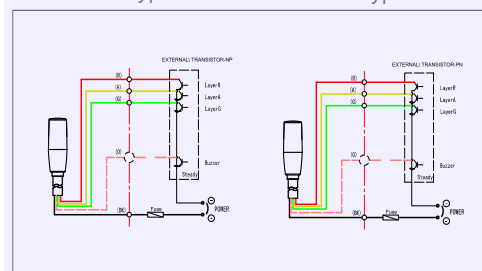

Connect type: Contact type

